

# PRODUCT CATALOG



**FLOW  
SENSOR**

MADE IN TAIWAN

[WWW.RICHTECH.COM.TW](http://WWW.RICHTECH.COM.TW)

**WFS-050VCM-A5**



**WFS-075VCM-A5**



**◆Dimensions**

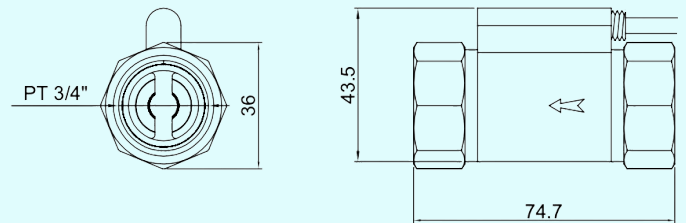
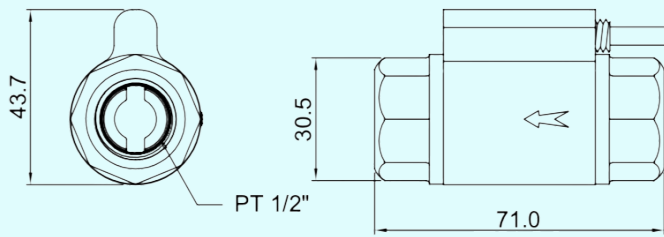

**WFS-050VSM-A5**



**WFS-075VSM-A5**



**◆Dimensions**

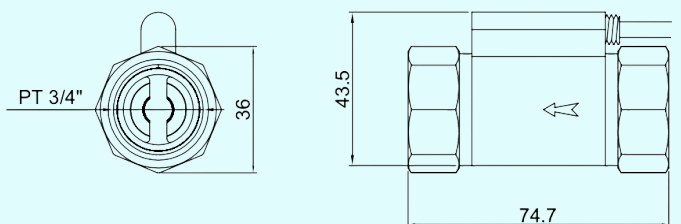
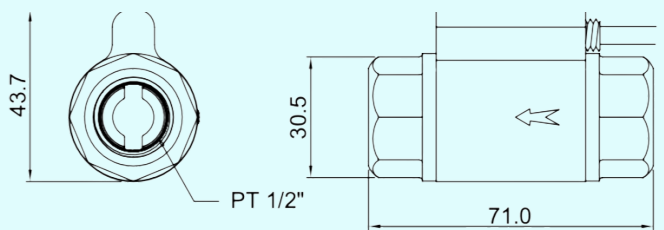

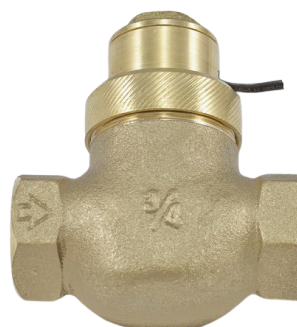
**WFS-050HCL-A5****WFS-075HCX-A5**

## ◆Dimensions

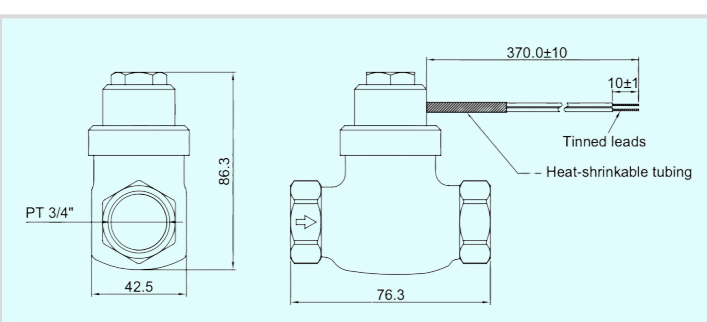
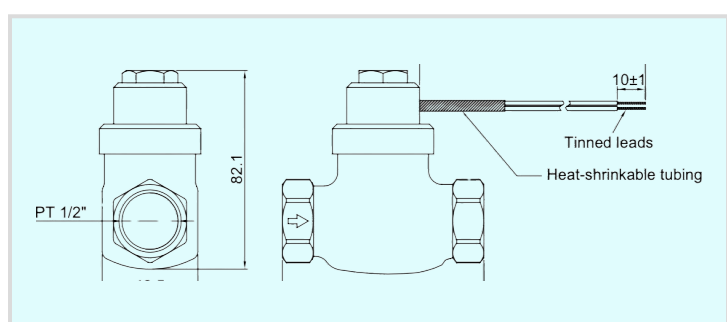
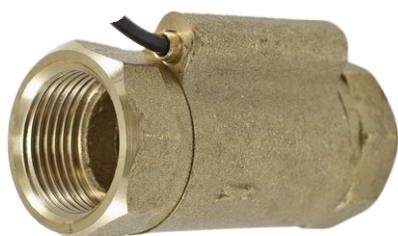
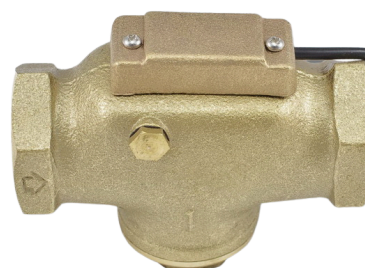
**WFS-100VCL-A5****WFS-100VCX-A5**

## ◆Dimensions

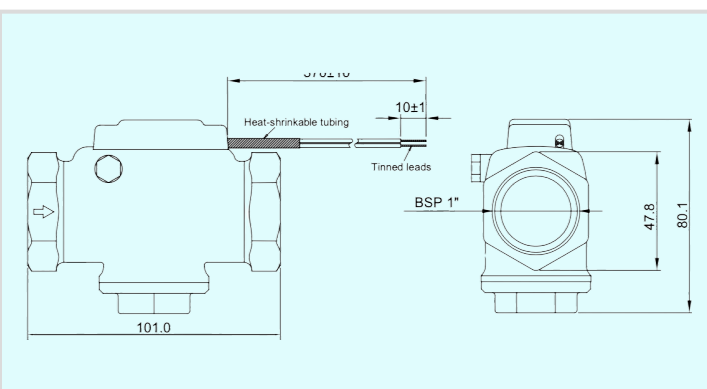
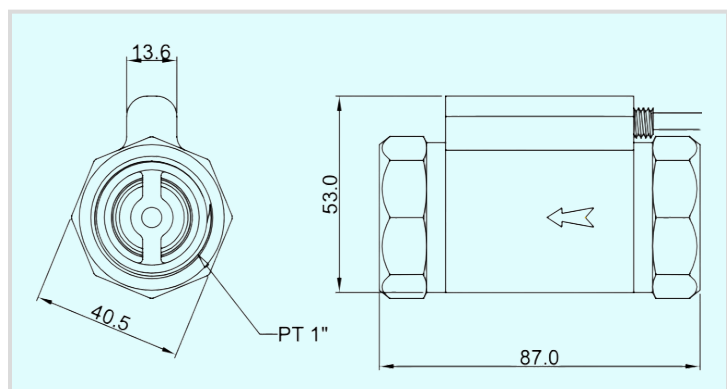

◆Switch Specifications

Description	Type	WFS-050V WFS-075V	WFS-050H WFS-100V	WFS-075H WFS-100V
Contact Rating Max		50W SPST		
Switching Voltage Max		250VAC / 200VDC		
Switching Current Max		500mA		
Carry Current Max		1A		
Lead Wire		UL 2462 22AWG 2C PVC		
Operating Flow Rate / Min		M=3, ± 1	L=5, ± 1	X=8, ± 1
Operating Temperature		0 ~ 80°C		
Material		Copper C84400 / SUS 304		

## Order Information

# Flow Switches

WFS

A5

### Connection :

050 = PT 1/2"  
075 = PT 3/4"  
100 PT 1"

### Mounting :

V = Vertical & Horizontal  
H = Horizontal

### Operation Flow Rate/Min :

M =  $3 \pm 1$  LPM  
L =  $5 \pm 1$  LPM  
X =  $8 \pm 1$  LPM

### Material :

C = Copper  
S = SUS304 (050V, 075V)

### A5

A = SPST, Normal Open  
5 = 50W, 250VAC/200VDC